



**2024**  
**Faculty and Student**  
**Research Conference**

**Mercer University**  
**Atlanta Campus**  
**Administration & Conference Center**

**Saturday, April 6th, 2024**  
**10am - 3pm**

*Sponsored By:*

**The Office of the Provost**  
**College of Professional Advancement**  
**College of Health Professions**  
**Georgia Baptist School of Nursing**

Welcome to the 14th annual Atlanta Faculty and Student Research Conference. This program contains information about the various presentations, including specific times and locations.

---

## Conference Schedule Overview

<u>Time</u>	<u>Session Type</u>
9:30-10:00	Registration
10:00-10:20	Welcome & Awards
10:20-11:20	Keynote Panel Discussion
11:30-12:20	Poster Session 1
12:30-1:00	Lecture Session 1 (15 & 30 minute talks)
1:00-1:30	Lunch
1:30-2:20	Poster Session 2
2:30-3:00	Lecture Session 2 (15 & 30 minute talks)

---

### WELCOME & SWILLEY LIBRARY RESEARCH AWARDS 10:00 - 10:20

2<sup>nd</sup> Floor Auditorium

1. **Welcome.** Priscilla Danheiser, Dean, College of Professional Advancement, & Wayne Glasgow, Senior Vice Provost for Research, Mercer University
2. **2024 Swilley Library Student Research Awards Presentation.**

**Presenter:** Kim Eccles, Associate Professor and Assistant Dean for Research Services, Swilley Graduate and Professional Library.

**Winner:** Dedeepya Pasupuleti, College of Pharmacy.  
Novel Nanoparticulate System Using Microfluidics to Enhance Central Drug Availability of Aspirin.

**Runner Up:** Katie Holliday, College of Health Professions.  
Improving Digestion and Nutrition in Post-Whipple Procedure Patients.

## KEYNOTE PANEL DISCUSSION

10:20 - 11:20

2<sup>nd</sup> Floor Auditorium

### *Exploring Psychedelics: Insights from Multidisciplinary Perspectives*

---

The 2024 Keynote Panel is comprised of an esteemed group of professionals from varied disciplines sharing their research and expertise on psychedelics.



Moderator:

Hollis Phelps, Associate Professor of Interdisciplinary Studies, College of Professional Advancement.



Panelists:

Brittany Prioleau, Assistant Professor of Counseling, College of Professional Advancement.



Clinton Canal, Associate Professor of Pharmaceutical Sciences, College of Pharmacy.



Peter Hendricks, Professor, Psychiatry & Behavioral Neurobiology, University of Alabama at Birmingham.



Gary Laderman, Professor, American Religious Histories and Cultures, Emory University.



John Tumeah, Psychiatrist, Foundation Psychiatry.

## POSTER SESSION 1

11:30 – 12:20

### 2nd Floor Atrium

1. **Patient-Centered Physical Therapy Management of a Novel Procedure: Meniscal Root Repair.** Brett Beavers & Jeffrey Ebert, College of Health Professions.
2. **Is Blood Flow Restriction an Effective Intervention?: A Critically Appraised Topic.** Taylor Brooks & Rachel Le, College of Health Professions.
3. **The Effects of Grit on Burnout Rates Among NCAA Athletes: A Critically Appraised Topic.** Briana Jordan & Rachel Le, College of Health Professions.
4. **Use of a Multi-Modal Approach in Trauma-Informed Physical Therapy for Complex Pain: A Case Report.** Matthew Wild & Leslie Taylor, College of Health Professions.
5. **Anal Squamous Cell Carcinoma: An Overview.** Amanda Kelley & Robert Baeten, College of Health Professions.
6. **The Impact of Reflection-Enhancing Strategies on Student Attitudes Towards People with Disabilities.** Lisa Fraher & Ann Lucado, College of Health Professions.
7. **An Introduction to Lifestyle Medicine as a Healthcare Approach.** Mackenzie Daniels & Erin Lepp, College of Health Professions.
8. **Understanding the Link Between Sleep Disturbances and Parkinson's Disease.** Emily Thomas & Jennifer de la Cruz, College of Health Professions.
9. **Glioblastoma Multiforme: Overview of Disease and Treatment Options.** Charlotte Wood & Jim Barker, College of Health Professions.
10. **The Recognition and Management of Actinic Keratoses.** Alysha Naran & Erin Lepp, College of Health Professions.
11. **Unlocking Potential: Intensive Physical Therapy Prior to Selective Dorsal Rhizotomy.** Sarah Roach & Lisa Fraher, College of Health Professions.

## POSTER SESSION 1 (cont.)

12. **Contributions of Malignant Neoplasms, Heart Diseases, and Rurality to Premature Death in Georgia.** Yessenia Castillo, Christine Vo, Diana Ghebrezadik, Sonita Simelus, Iyanuoluwa Daomi, Shravani Sirsat, Brittany Daniels, Cathony Reid, Mellanese Cobb, Angelina Callaway Williams, Faith Luke, Janee Demery, Desiree Smith, Suzie Madden, David Ombengi, Michelle Penn-Marshall, & Dawood Sultan, College of Health Professions.
13. **Ovarian Cancer: What Are We Still Missing?** Alexis Hada & Shannon Jackson, College of Health Professions.
14. **Multimodal Vasopressor Therapy in Septic Shock.** Catherine French & Tejal Desai, College of Health Professions.
15. **Comparison of the Efficacy/Safety Treatment of Sickle Cell Disease within the Pediatric Population.** Jasmine Weaver, College of Pharmacy.
16. **Intranasal and 3D Printing Technology for Zika Virus Vaccine Delivery.** Sarthak Shah, Payal Patel, Akanksha Kale, Priyal Bagwe, Mohammad Uddin, & Martin D'Souza, College of Pharmacy.
17. **Using Dissolving Microneedles as a Delivery System for Influenza Vaccine.** Emmanuel Adediran, College of Pharmacy.
18. **Delivery of Bivalent Covid-19 Vaccine Through Microparticles Using Microneedles.** Tanisha Manoj Arte, Smital Patil, & Martin D'Souza, College of Pharmacy.
19. **Invitro Assessment of Nanoparticulate Vaccine Capability in Fostering Adaptive Immunity.** Dedeepya Pasupuleti, Amarae Ferguson, Priyal Bagwe, Sharon Vijayanand, Susu Zughaiyer, & Martin D'Souza, College of Pharmacy.
20. **Optimizing Dosage in a Novel Microparticulate Gonococcal Vaccine.** Amarae Ferguson, Priyal Bagwe, Susu Zughaiyer, & Martin D'Souza, College of Pharmacy.
21. **Evaluating Involvement of the Melatonin Receptor System in Depression.** Tyanna Brown & Renée Hayslett, College of Pharmacy.
22. **Pressure Myography for Real-Time Measurement of Arterial Contractility.** Rachel Deryck & Raquibul Hasan, College of Pharmacy.

POSTER SESSION 1 (cont.)

23. **Cardiovascular Dysfunction in COVID-19: The Role of Infective Versus Non-Infective Mechanisms.** Hala Obideen, Ajay Pandey, & Raquibul Hasan, College of Pharmacy.
24. **Enhanced Transdermal Delivery of Lurasidone for Potential Treatment of Schizophrenia.** Ariana Radmard & Ajay Banga, College of Pharmacy.
25. **Inhaled H182-cSS-pegNL Lipid Nanosuspension Product: Effective Therapy for Severe Asthma Management.** Snehitha Akkineni, Rama Kashikara, Tro Ngyugena, Arun Kumar Kothaa, John Lea, Yash Harsodaa, Francisco Lopez-Tapiab, James Turksonb, & Mahavir Bhupal Chougulea, College of Pharmacy.
26. **Characterization of Inhalable Nanoliposomes Loaded with TMPRSS2 Inhibitor for the Treatment of COVID.** John Le, Rama Kashikar, Jacco Boon, Jim Janetka, & Mahavir Chougule, College of Pharmacy.
27. **Reduction of Workplace Violence Towards Nurses Working in the Emergency Department.** Savanna Long & Jordan Mecredy, Georgia Baptist College of Nursing.
28. **The Effects of Mindfulness Meditation on Burnout and Compassion Fatigue Levels in Acute Care Nurses.** Folashade Dada, Georgia Baptist College of Nursing.
29. **Metacognitive Awareness of Student Researchers.** Deana Ford & Scott Bassett, Tift College of Education.
30. **Preliminary Workings of an SEL-Adult Instrument.** Rachael VanDonkelaar, Tift College of Education.
31. **Weight Training Effect on High School Students' FitnessGram Scores.** Jaylon Harden, Tift College of Education.
32. **A Systematic Review of Literature on Faculty Governance Using Artificial Intelligence.** Jim Vander Putten, Tift College of Education.
33. **In His Own Backyard: A Primary Analysis of the Work of Dr. J Marion Sims.** Krystle Freeman, College of Professional Advancement.
34. **Burnout in VA Nurses and its Relationship to Job Satisfaction.** Sherita Stringer, College of Professional Advancement.

## POSTER SESSION 1 (cont.)

35. **College Debt Amongst Graduate Students.** Tanesha Harmon, College of Professional Advancement.
36. **Burnout and Job Satisfaction of DFCS Child Welfare Social Workers.** Latasha Williams, College of Professional Advancement.
37. **Immigration Age Influence on Cognitive Ability within the Elderly Hispanic Population.** Anna Ross & Kimberly Roth, College of Professional Advancement.
38. **Meaning in Life: A Revolutionized Meaning-Making Instrument for Young Adults.** V. Alexander Ayvazian, College of Professional Advancement.
39. **Relational Satisfaction as a Predictor of Graduate Students' Academic Achievement.** Veronica Stewart & Brandy Velazquez, College of Professional Advancement.
40. **How Religion Causes Hospital Protocol Heresy Under the Emergency Medical Treatment and Labor Act.** Kimberly Lancaster, College of Professional Advancement.
41. **The Effects of Xylazine ("Tranq") on the Cardiovascular and Respiratory Systems.** Jendayi Griggs, Jermaine Crockett, Sabiha Mirza, Shavon Womack, & Sabrina Walthall, College of Professional Advancement.
42. **Effects of the Great Pacific Garbage Patch (GPGP) on the Human Digestive & Reproductive Systems.** Jasmine Williams, Jeselyn Alcantara, Jason Anderson, Ronda Kilgore, & Sabrina Walthall, College of Professional Advancement.
43. **Moral Distress and Brain Death: Managing the Process as an Interprofessional Team.** Alaina Joiner, Caroline Anglim, & Jennifer Bartlett, School of Medicine.
44. **Experiences and Outcomes of Two African American Women Engaging in Mindfulness Via Telehealth.** Dayva Hubbard & Amanda Denzer-King, School of Medicine.

## LECTURE SESSION 1

12:30 – 1:00

### 30 minute talks:

ACC 175 (12:30-1:00)

**Preparing for Age-Friendly Care: A Health Humanities-Focused IPE Using Photography and the 4Ms Framework.** David Taylor, Leslie Taylor, Beth Collier, Jennifer de la Cruz, & Mark Stillman, College of Health Professions; Susan W. Miller, College of Pharmacy; & Omolara Fyle-Thorpe, Georgia Baptist College of Nursing.

ACC 555 (12:30-1:00)

**Application of an Impairment Based Treatment Framework for Lateral Ankle Sprains.** Caitlin Forkin & Nicholas Orton, College of Health Professions.

ACC 240 (12:30-1:00)

**Exploring Patient Autonomy Culture in Select Healthcare Teaching Settings: How Does Culture Affect Attitudes About Consent.** Kimberly Lancaster & Melissa Carrie, College of Professional Advancement.

ACC 280 (12:30-1:00)

**Using Bowen Family Systems Theory's Concept of Triangles with High Conflict Couples.** Jetlexis Carlos, School of Medicine.

### 15 minute talks:

ACC 243 (12:30-12:45)

**Healthcare Education: Exit Exams and Registry Predictions.** Amanda Price, Tift College of Education.

ACC 243 (12:45-1:00)

**Business Student Admissions Test Scores as a Predictor for Undergraduate Student GPA.** John Wilson Gordon, Tift College of Education.



15 minute talks:

ACC 245 (12:30-12:45)

A Compassionate Approach to Pain: A Qualitative Journey Through Women's Experiences of Self-Compassion and Gratitude interventions for Chronic Pain Management. Michelle Shlafman, College of Professional Advancement.

ACC 245 (12:45-1:00)

Exploring the Challenges and Perspectives in Reproductive Healthcare Encountered by Transgender Men. Jordyn Alderman, College of Professional Advancement.

---

LUNCH  
1:00 - 1:30

2nd Floor Atrium

---

Community-Based Research Interest Group  
2:00

ACC 280 (2nd floor Auditorium)

Dr. Rob Helfenbein is facilitating an open forum for faculty across disciplines to discuss community-based research and collaboration. Discussion topics include: Who is engaged or interested in community based research? What kinds of projects are in the works? What are some of the challenges of doing this type of work?

All faculty and students are invited to attend!

## POSTER SESSION 2

1:30 – 2:20

### 2nd Floor Atrium

1. **Recognizing and Managing Neonatal Sepsis.** Tucker Buffington & Lauren Hoover, College of Health Professions.
2. **CAR NK Cell Therapy – A Futuristic Approach to Hematologic and Lymphoid Cancer.** James Berry & Robert Baeten, College of Health Professions.
3. **Managing the Obesity Pandemic: Approaches for Adults with Low Socioeconomic Status.** Ciandra Calhoun & Suzanne Nelson, College of Health Professions.
4. **Improving Digestion and Nutrition in Post-Whipple Procedure Patients.** Katie Holliday & Robert Baeten, College of Health Professions.
5. **IPAA Surgery for Ulcerative Colitis: Standards of Care and Updates to Surgical Technique.** Vivie Lee & Amanda Clark, College of Health Professions.
6. **Navigating the Digestive Dilemma of Disordered Eating: Anorexia Nervosa and Delayed Gastric Emptying.** Emma Tierney & Amanda Clark, College of Health Professions.
7. **Update on Practice Guidelines for Management of Low-Risk Acute Pulmonary Embolism.** Emily Becker & James Barker Jr., College of Health Professions.
8. **Pulmonary Embolism Management Utilizing EKOS® Ultrasound Assisted Catheter Directed Thrombolysis.** Meghan Barber & Tejal Desai, College of Health Professions.
9. **Nursing Students' Perceptions of Barriers to Providing Age-Friendly Care.** Beth Collier, Leslie Taylor, & Omolara Fyle-Thorpe, College of Health Professions.
10. **Identifying Risk Factors for Prompt Diagnosis of Chronic Thromboembolic Pulmonary Hypertension.** Jacqueline Terrini & Julian Albritton, College of Health Professions.

## POSTER SESSION 2 (cont.)

11. **Gut Microbiome Dysbiosis: The Utilization of Preventative and Therapeutic Nutritional Interventions.** Elizabeth Quirk & Amanda Clark, College of Health Professions.
12. **Is My Heartburn GERD or a Tumor? A Clinical Review of Zollinger Ellison Syndrome.** Kellie Wydrinski & Robert Baeten, College of Health Professions.
13. **The Therapeutic Potential of Psilocybin in Treating Anxiety and Depression.** Chelsea Mackay & Jill Mattingly, College of Health Professions.
14. **Race-Related Stress and Trauma Measures: A Systematic Literature Review.** Gail Kemp, Sherree Clark-Metcalf, & Jadin Marshal, College of Health Professions.
15. **A Holistic Approach to the Management of Metabolic Syndrome.** Clara Arroyo & Jennifer de la Cruz, College of Health Professions.
16. **Retrospective Study: Investigating the Influence of Adverse Childhood Experiences on Breastfeeding.** Stacia Wilson, College of Health Professions.
17. **Recognizing and Diagnosing PTSD in the Pediatric Population: A Selective Cohort of Children in Kisumu.** Sydney Smith & Jill Mattingly, College of Health Professions.
18. **Indole-3 Acetic Acid Induces Vasodilation by Stimulating Endothelial Nitric Oxide Production.** Morgan Jones, Sreelakshmi Menon, Farzana Zerín, Emmanuella Ezewudo, & Raquibul Hasan, College of Pharmacy.
19. **Exploring a Novel Inhibitor for the Endothelin System.** Nimi Pullenkunnel Simon, Sreelakshmi Menon, Farzana Zerín, Emmanuella Ezewudo, Nader Moniri, Taufiq Rahman, & Raquibul Hasan, College of Pharmacy.
20. **Neflamapimod Suppresses Endothelium Activation and Leukocyte Attachment Induced by LPS-stimulation.** Sreelakshmi Nandakumar Menon, Farzana Zerín, Emmanuella Ezewudo, Nimi P Simon, Nader Moniri, & Raquibul Hasan, College of Pharmacy.

## POSTER SESSION 2 (cont.)

21. **Indole-3-acetic Acid Modulates Vascular Dysfunction and Hypertension in Salt-sensitive Models.** Emmanuella Ezewudo, Farzana Zerín, Sreelakshmi Menon, Tro Nguyen, Mahavir Chougule, Taufiq Rahman, & Raquibul Hasan, College of Pharmacy.
22. **Novel Nanoparticulate System Using Microfluidics to Enhance Central Drug Availability of Aspirin.** Dedeepya Pasupuleti, Marissa D'Souza, Sharon Vijayanand, Emmanuel Adediran, Amarae Ferguson, & Martin D'Souza, College of Pharmacy.
23. **Radioligand Binding for Pharmacodynamic Characterization of Small Molecules.** Christopher Tutterow, College of Pharmacy.
24. **Neuropathology Associated with Spontaneous Seizures in Fmr1 Knockout Mice.** Thomas Dick, Tanishka Saraf, Jessica Armstrong, Caylee Durden, & Clinton Canal, College of Pharmacy.
25. **Evaluating Cognitive Rigidity in a Mouse Model of Fragile X Syndrome: A New Assay with Enhanced Constructive Validity.** India Rayne Breuer & Clinton Canal, College of Pharmacy.
26. **Developing and Evaluating an Anti-epileptic Transdermal Patch of Lamotrigine for Pediatric Patient.** Meheli Ghosh & Ajay Banga, College of Pharmacy.
27. **Small Molecule Cyclic Sulfonylurea Inhibitors of SUR1.** Jonathan Parker Vincent, Amol Kulkarni, J. Marc Simard, & J. Phillip Bowen, College of Pharmacy.
28. **Development of 3D-printed Transdermal Films of Pramipexole Dihydrochloride for Parkinson's Disease.** Anuradha Dey, Thomas Kipping, & Ajay Banga, College of Pharmacy.
29. **Topical and Transdermal Delivery of Bupivacaine using Novel Pen Delivery System.** Nethra Viswaroopan, Chao Zhao, & Ajay Banga, College of Pharmacy.
30. **Effects of Mindfulness on Compassion Fatigue and Satisfaction in Formal Older Adult Caregivers.** Immani Mays, Georgia Baptist College of Nursing.

## POSTER SESSION 2 (cont.)

31. **Addressing Childhood Malnutrition Education and Nutritional Access Barriers in Rural Delhi, India.** Madison Stinson, Georgia Baptist College of Nursing.
32. **Participatory Research and Emancipatory Archiving as Educational Research Methods for Justice.** Leah Panther, Katherine Perrotta, Lucy Gitonga, Merlong Taylor, Latise McCord, Rosi Sanchez, & Summiya Robinson, Tift College of Education.
33. **Department of Family and Children Services (DFCS) Social Workers Struggling with Secondary Trauma.** LaShana Taylor, College of Professional Advancement.
34. **The Effects of Food Insecurity in Middle Georgia Households.** Nakeya Reese, College of Professional Advancement.
35. **Impact of Adopting Children in the State of Georgia.** Peter Almeida, College of Professional Advancement.
36. **Exploring the Factors to Encourage College Students to Buy Instead of Renting Property While in College.** Crystal Jackson, College of Professional Advancement.
37. **Neighborhood Composition Influence on Cognitive Ability within the Elderly Hispanic Population.** Anna Rios & Kimberly Roth, College of Professional Advancement.
38. **Exploring Imposter Syndrome in School Counselor Master's Students: Unveiling the Power of Support.** Victoria Lindsay & Renete' Washington, College of Professional Advancement.
39. **Marital Attitudes Among Men.** JaiDei Jackson & Ebonee James, College of Professional Advancement.
40. **Exploring the Healing Canopy: A Conceptual Study on the Efficacy of Nature-Based Interventions for Black Women.** Tomeco Woods & Khaleedah Dickerson, College of Professional Advancement.
41. **Genetic Mapping of Mutant L4.1 in Drosophila Melanogaster.** Jasmine Moultrie, Bruce Allen, Essie Cowell, Corynne Payne, & Sabrina Walthall, College of Professional Advancement.

## POSTER SESSION 2 (cont.)

42. **The Synthetic Opioid, Fentanyl, Impact on the Reproductive and Cardiovascular System.** Lakita Walker, Andrea Davis, Kimberly Freeman, Keisha Hosey, Jacqueline Mutisya, & Sabrina Walthall, College of Professional Advancement.
43. **The Mane Issue: Training Black Hairstylists and Their Clients on EDCs' Risks in Hair Products.** Desiree Smith, Myesha Iqbal, Lorraine Thomas, Maliyah Womack, & Diamond Spratling, College of Health Professions.
44. **Attitudes and Responses to Miscarriage Through the Lens of Ambiguous Loss: A Case Study.** Rachel Zimmerman, School of Medicine.
45. **Exploring Non-Traditional Parenting Systems: A Case Study on Collaborative Parenting.** Jasmin Copeland, School of Medicine.
46. **Covid Impact on Chick-fil-A.** Sharon Nancy, Stetson-Hatcher School of Business.

## LECTURE SESSION 2

15-minute and 30-minute talks

2:30 – 3:00

### 30 minute talks:

ACC 175 (2:30-3:00)

**Functional Outcomes of Blood Flow Restriction Therapy for a Patient Who is Noncompliant Following a Total Knee Arthroplasty (TKA).** Kathleen Schwab & Tim McMahon, College of Health Professions.

ACC 243 (2:30-3:00)

**Mental Health Literacy in Black Congregations: Education, Partnership, and Capacity Building.** Gail Kemp & Tasia Blair, College of Health Professions.

ACC 555 (2:30-3:00)

**Student Participation in Enriched Critical Citizenship Education about the COVID-19 Pandemic.** Katherine Perrotta & Katlynn Cross, Tift College of Education.

ACC 240 (2:30-3:00)

**Global Research Symposium: Immigration and Multiculturalism.** Arla Bernstein, College of Professional Advancement.

## LECTURE SESSION 2 (cont.)

2:30 – 3:00

### 15 minute talks:

ACC 181 (2:30-2:45)

**The Complexities of the Helper Syndrome and the Mental Health Professional.** JaiDei Jackson & Ebonee James, College of Professional Advancement.

ACC 182 (2:30-2:45)

**The Impact of International Service-Learning Trips on Social Entrepreneurship Intentions.** Kibeom Park, Briana Stenard, Myriam Quispe-Agnoli, Vijaya Subrahmanyam, Etienne Musonera, Clavia Coretta Waite, & Steven Frasier Holman, Stetson-Hatcher School of Business.

ACC 245 (2:30-2:45)

**Use of Information Technology Practices and Software for Traditional Medicine Recording.** Sylvia Iroabuchi, College of Professional Advancement.



Thank you for joining other students and faculty members from all of the colleges and schools on the Atlanta campus and Regional Academic Centers for the Mercer Atlanta Research Conference. We offer this Conference to showcase and celebrate our students' and our faculty's scholarly work. I want to express my sincere appreciation to Dr. Cameron Miller, for his annual leadership of this Conference.

Additionally, thanks to the other planning committee members including: Erin Lepp with the College of Health Professions, Nader Monir with the College of Pharmacy, Rob Helfenbein in the Tift College of Education, Arnab Nayak with the Stetson-Hatcher School of Business, Tessa George with the Georgia Baptist School of Nursing, and Suneetha Manyam, Stephen Ruegger, Awatef Ben Ramadan, Stefanie Sevcik, and Dina Schwam, in the College of Professional Advancement.

Priscilla R. Danheiser, Ph.D.  
Dean, College of Professional Advancement

## ACC Building: 1st and 2nd Floor Plans with Room Numbers

ACC 1st Floor

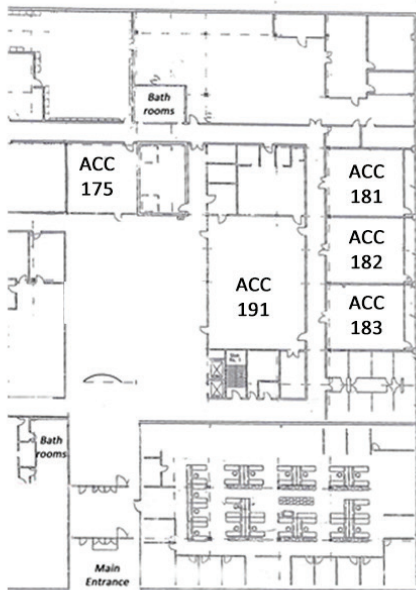

Thank You for attending the  
Faculty and Student Research Conference!

ACC 2nd Floor

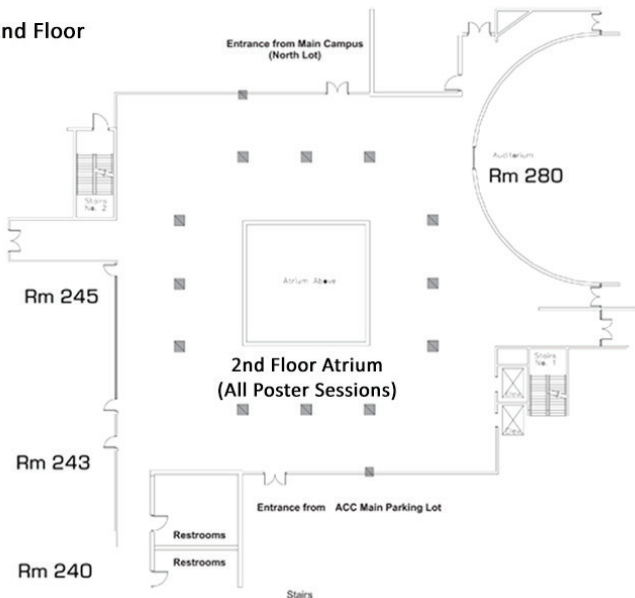

*Note: Internal stairs do not connect 1st and 2nd floors;  
only the elevator and external stairs do.*